

omega
altise

**O40P & O46P
40cm and 46cm
Pedestal Fans**



**Instruction
Manual**

Important Safety Instructions

1. Read all instructions.
2. Disconnect the power plug before dismantling, assembling or before cleaning.
3. Avoid touching mobile parts of the fan.
4. Make sure the fan is on a dry and even surface.
5. Never insert fingers, pencils or any other objects through the guards whenever the power plug is connected, especially while running.
6. The appliance is not intended for use by young children or infirm persons unless they have been adequately supervised by a responsible person to ensure that they can use the appliance safely.
7. Young children or infirm persons should be supervised to ensure that they do not play with the appliance.
8. Do not use the appliance for any other purpose than its intended use.
9. The fan must not be used if the guards are not fastened according to instructions.
10. When the power cord is damaged, it must be replaced by the manufacturer or its service agent or a similarly qualified person in order to avoid a hazard.
11. Do not use your appliance with an extension cord unless it has been checked and tested by a qualified electrician or electrical supplier.

Read all instructions before using this unit. Keep them for future reference.

Specifications

Model	O40P	O46P
Rated Voltage	220-240V / 50Hz	
Watts	50W	70W
Controls	Manual - Swing control pin	

Settings	3 speed	
Fan blade size	40cm	46cm
Tilt action	Tilting fan head	
Oscillation	Oscillating fan head	
Warranty	2 year replacement	

Parts List

1. Front grille
2. Blade cap
3. Blade
4. Grille locking nut
5. Rear grille
6. Motor housing
7. Swing control pin
8. Pedestal pole
9. Switch handle
10. Base

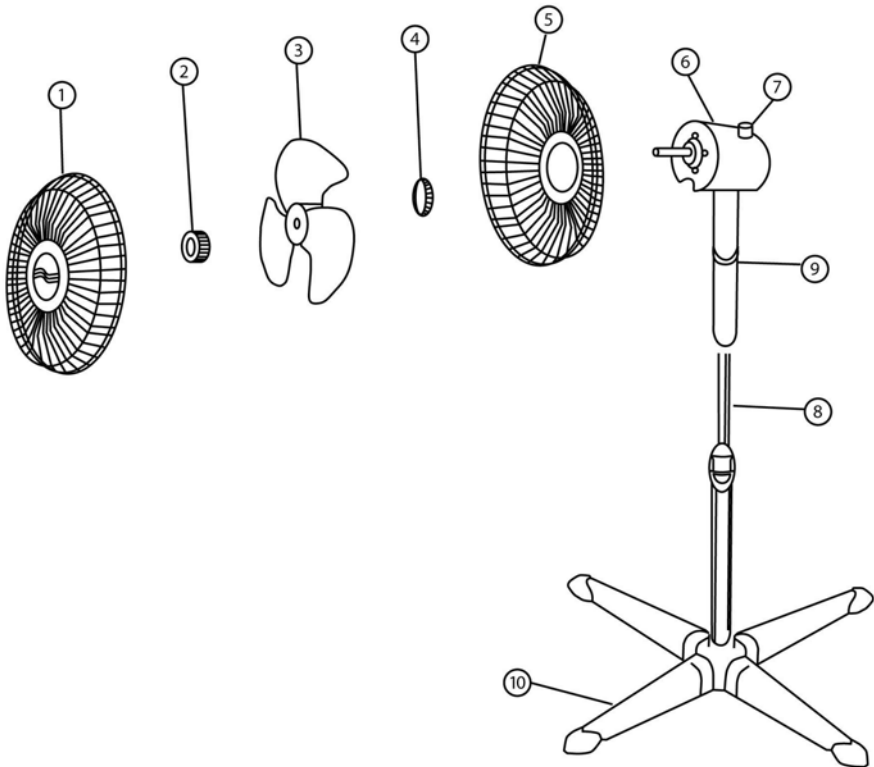

Assembly Instructions

Base Assembly

1. Remove all items of packaging from the fan.
2. Slide the four base pieces into the centre base cap. You can hear a click when it is slid into position. See Figure 1.
3. Slide the pedestal pole into the centre cap. See Figure 2.

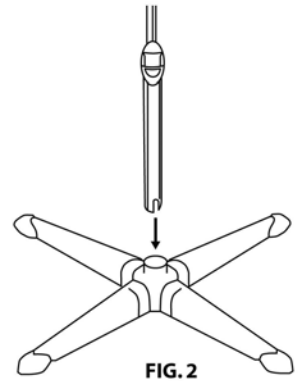
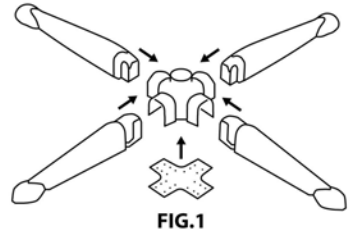

Fan Head Assembly

1. Loosen the height adjustment ring by twisting it to the left and extend the inner pipe. Initially the pedestal pole may be tightly held in place, if necessary, use a pair of pliers to grasp and pull it up to position. Retighten the height adjustment ring.
2. Place the switch compartment onto the stand bar and secure in place.
3. Remove the blade cap from the motor shaft by turning it clockwise. Then remove the locking nut by turning it anti-clockwise.
4. Place the rear grille into position, ensuring that it is aligned with the 3 locating lugs. If this is done correctly, the carry handle on the grille will be at the top.
5. Fix the grille into position by replacing the rear grille locking nut tightly by hand. Do not force the locking nut.
6. Insert the blade onto the motor shaft by matching the D type slots in the blade with the motor shaft.
7. Fix the blade into place by gently hand tightening the blade cap onto the motor shaft in an anti-clockwise direction. Do not over tighten.
8. Open all locking clips on the front grille.
9. Place the front grille into position and secure it by fastening the clips over the outer rim.

Operating Instructions

1. Use in a dry place, free of excessive humidity and water.
2. To set the fan in motion set the swing control pin to the desired location on the speed control assembly:
0 = OFF 1 = LOW 2 = MEDIUM 3 = HIGH
3. Set the swing control pin to 0 and unplug the power cord when the fan is not in use.
4. For oscillation, press down on the knob at the top of the motor housing. To stop oscillation pull the knob upwards.
5. To adjust the height of the fan, loosen the height adjustment ring on the pedestal pole of the fan, adjust to the required height and retighten.

Fan Direction Adjustment

1. Do not attempt to make any adjustment to the direction of the grille and fan assembly until the fan has been turned off and unplugged from the socket.
2. To adjust the direction of the fan, hold the grille and gently tilt the fan until the desired position is reached.
3. Plug the fan back into the socket and turn the fan on.

Care and Maintenance

1. Always disconnect the cord from the electrical outlet when cleaning your fan.
2. Light accumulated dust may be removed from the fan with a soft cloth or vacuum cleaner using the dusting brush attachment.
3. Wipe the exterior surfaces of the fan occasionally with a cloth moistened (not dripping wet) with a mild soap solution. Dry the case thoroughly with a soft dry cloth before operating the fan.
4. Avoid the use of gasoline, benzine, thinner etc as they may result in damage to the fan.
5. Store the fan in a clean dry place when not in use.



CAUTION! Do not immerse the fan in water or allow water to drip into the interior of the fan housing as this could create a fire or electric shock hazard.



WARNING! Do not attempt to open or repair the fan yourself. Doing so could void the warranty and cause damage or personal injury.

Omega Altise products are distributed in Australia by MEA,
(A Division of Hagemeyer Brands Australia Pty Ltd)

ABN 28 001 375 686

Locked Bag 4013, Kingsgrove NSW 2208

Phone: 1300 739 033

Fax: 1800 838 899

Email: customerservice@meappliances.com.au

Web: meappliances.com.au