

omega
altise

**Oil Filled
Column Heaters**

OC1005

OC1507

OC2009

OC2411

OC2411T



**Instruction
Manual**

OC SERIES: OIL FILLED COLUMN HEATERS

Read all instructions before using this appliance. Keep them for future reference.

Safety Instructions

- This appliance is not intended for use by young children or infirm persons unless they have been adequately supervised by a responsible person to ensure that they can use the appliance safely;
- Young children should be supervised to ensure that they do not play with the appliance;
- **WARNING:** In order to avoid overheating, do not cover this heater;
- The heater must not be located immediately below a socket-outlet;
- Do not use this heater in the immediate surroundings of a bath, a shower, or a swimming pool;
- This heater is filled with a precise quantity of special oil. Repairs requiring opening of the oil container are only to be made by the manufacturer or their service agent who should be contacted if there is an oil leak;
- When scrapping the heater, follow regulations concerning the disposal of oil;
- If the supply cord is damaged it must be replaced by the manufacturer, authorised service agent, or similarly qualified persons in order to avoid a hazard;
- **CAUTION:** In order to avoid a hazard due to inadvertent resetting of the thermal cut-out, this appliance must not be supplied through an external switching device such as a timer, or connected to a circuit that is regularly switched on and off by the utility;
- Please do not place your clothes or towel on the radiator for fear of over heating.

WARNING - THIS APPLAINCE MUST BE EARTHED.

This heater must be used on an AC supply only and the voltage marked on the heater must correspond to the supply voltage. Before switching on, please read the safety warnings and operating instructions.

Product Range

Model	Rated voltage	Rated power	Specification	
OC1005	240V	1000W	5 fin	Adjustable thermostat, 24 hour timer, turbo fan, cord storage, humidifying cup
OC1507	240V	1500W	7 fin	
OC2009	240V	2000W	9 fin	
OC2411	240V	2400W	11 fin	
OC2411T	240V	2400W	11 FIN	Adjustable thermostat, 24 hour timer, cord storage, humidifying cup

Components

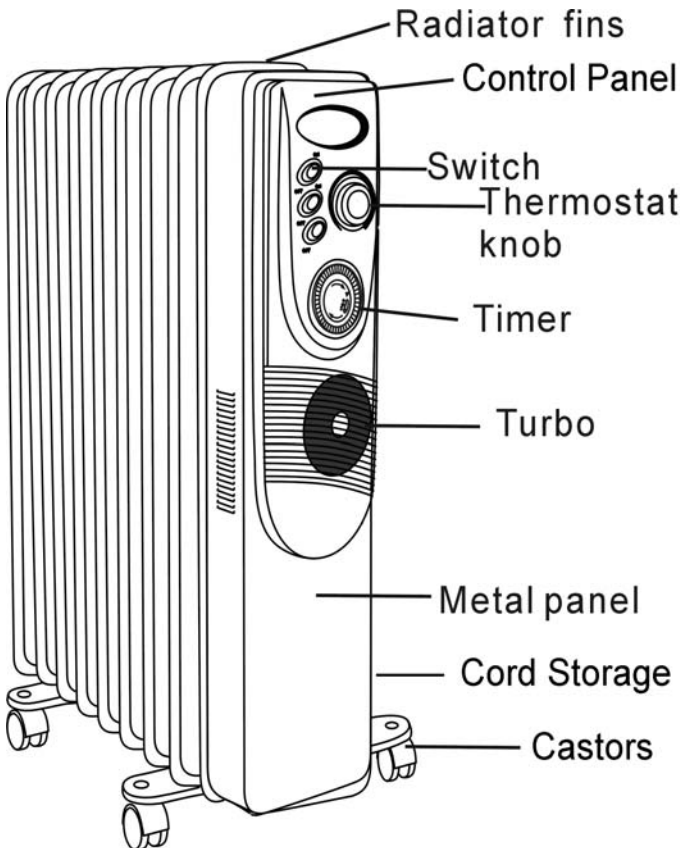

Model	Heat Switch Settings		
	Switch 1	Switch 1 & 2	Turbo Fan*
OC1005	500W	1000W	900W
OC1507	600W	1500W	1300W
OC2009	800W	2000W	1600W
OC2411	1000W	2400W	1800W
OC2411T	1000W	2400W	N/A
Fan only			400W

* Turbo Fan mode with switch 2 turned on.

Fitting the Castors

The heater is packaged with the castors unattached. You must attach them before operating the heater. Fit the castors to the mounting plates using the bolts provided. Note that the castors are designed to be a tight fit on the mounting plate but are designed to rotate freely during use.

- 1 Place the radiator body upside-down on a soft surface to avoid damage to the heater. Make sure it is in a stable position and will not fall.
- 2 Attach the castor mounting plate to the heater body:
 - a. Insert the non-threaded end of the U bolt into one of the two holes in the castor mounting plate (see fig 1).
 - b. Keeping this position, hook the U bolt around the body section that joins the last two fins and turn the U bolt until it lines up with the remaining hole in the castor mounting plate (see fig 2 and 3).
 - c. Secure the U bolt and mounting plate with the wing nut provided (see fig 4).
 - d. Repeat at the other end.
- 3 Return the unit to an upright position. It is now ready for use.

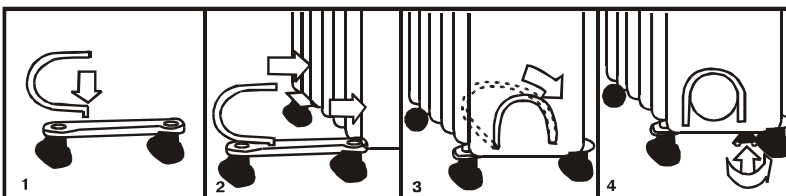

IMPORTANT: Do not operate without castors attached. The heater must only be operated in an upright position. Any other position could create a hazardous situation. Ensure that the castors are fitted to the base of the heater so that, when in use, the controls are at the top and the cable storage is at the bottom of the control panel.

Operating Instructions

Connect the heater into the power supply. The two power selector switches on the control panel provide a choice of half or full heat output to suit varying conditions and for economy of operation.

1. The upper switch turned on provides approximately half the heat output of the heater.
2. Both the upper and centre switch provides full heat output.
3. The bottom switch selects the fan boost function (Does not apply to OC2411T).
When it is switched the heater cuts back to one heat setting plus 400W turbo fan output.

Thermostat Control

Turn the thermostat knob fully clockwise to its highest position for maximum heat output to warm the room rapidly. When the room temperature has reached the desired level, turn the thermostat knob back slowly until the thermostat clicks off and the neon light goes out. The heater will then operate under the control of the thermostat to maintain the chosen temperature level, provided that the heater is of sufficient size for the room to be heated.

Humidifying Cup

The use of the humidifying cup is optional. To use the humidifying cup you will need to fill it with clean water and place the plastic cup over the fins at the top of the heater. The water will evaporate slowly during the heating process to place moisture into the warm air.

WARNING: The plastic cup and water will become hot during use so you will need to wait for it to cool before removing. Ensure that the heater is out of the reach of small children and observe all other safety precautions.

Using the Timer

The timer is a 24-hour programmable timer enabling the heater to be switched ON and OFF automatically if desired. The heater must be connected to the electricity supply for the timer to operate. The switch on the timer will also control the electricity supply to the elements when in use.

The timer has a small switch on the inside of the dial. The functions are as follows:

- O** = OFF (the unit will not work)
- I** = ON (manual operation)
-  = Timer function is ON



Manual Operation

Set the switch on the inside of the timer to the “I” position. The heater will now operate continuously under the control of the thermostat.

Automatic (Timer) Operation

To start you will need to set the current time. This is done by rotating the dial clockwise until the correct time of the day is indicated opposite the datum (▼) mark. Should the electricity supply to the heater be disconnected it will be necessary to reset the timer to the time of day.

Set the switch on the inside of the timer to the  position. Push the red pins outwards corresponding to the time you want the radiator to turn on. Push the pins in towards the centre corresponding to the time you want the radiator to turn off.

Each pin represents 15 minutes, so if heating is required for a 2 hour period 8 pins should be moved. The timers may be set to give as many ‘ON’ periods of any length as may be required over the 24 hour period. The program will repeat itself every 24 hours until changed or the unit is switched off at the power supply.

This program may be over ridden at any time by switching to Manual (I) or Off (O).

NOTE: The heater will not operate if the timer is set to the  position and the pins are not activated according to the times required.

Care and Maintenance

The heater requires regular cleaning to ensure trouble free operation:

- Turn the isolation switch off. For added protection, also turn the mains supply off.
- Use a damp cloth to clean the exterior of the heater. Do not use abrasive cleaning products on this appliance.
- Use a vacuum cleaner to remove dust and fluff from the inlet and outlet grilles.
- Ensure the heater is dry before turning the mains supply to the heater on.



CAUTION! Do not immerse the heater in water or allow water to drip into the interior of the fan housing as this could create a fire or electric shock hazard.



WARNING! Do not attempt to open or repair the heater yourself. Doing so could void the warranty and cause damage or personal injury.