

omega
altise

**OHVP40C, OHVP46C &
OHVP46
High Velocity
Pedestal Fans**



**Instruction
Manual**

Important Safety Instructions

1. Read all instructions.
2. Disconnect the power plug before dismantling, assembling or before cleaning.
3. Avoid touching mobile parts of the fan.
4. Make sure the fan is on a dry and even surface.
5. Never insert fingers, pencils or any other objects through the guards whenever the power plug is connected, especially while running.
6. The appliance is not intended for use by young children or infirm persons unless they have been adequately supervised by a responsible person to ensure that they can use the appliance safely.
7. Young children or infirm persons should be supervised to ensure that they do not play with the appliance.
8. Do not use the appliance for any other purpose than its intended use.
9. The fan must not be used if the guards are not fastened according to instructions.
10. When the power cord is damaged, it must be replaced by the manufacturer or its service agent or a similarly qualified person in order to avoid a hazard.
11. Do not use your appliance with an extension cord unless it has been checked and tested by a qualified electrician or electrical supplier.

Read all instructions before using this unit. Keep them for future reference.

Specifications

Model	OHVP40C	OHVP46C OHVP46
Rated Voltage	220-240V / 50Hz	
Watts	60W	120W
Dimensions (h x w x d) cm	140x54x42	160x56x40
Controls	Rotary switch	

Settings	3 speed, rotary switch control	
Fan blade size	40cm	46cm
Tilt action	Tilting fan head	
Oscillation	No	
Warranty	2 year replacement	

Parts List

1. L screw
2. Washer
3. Weight base insert
4. Decorative base plate
5. Screws (4)
6. Base tube
7. Decorate Cap
8. Extension tube locking nut
9. Extension tube
10. Fan head

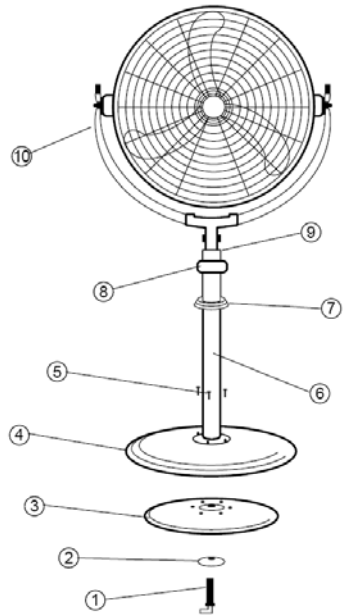

Assembly Instructions

1. Remove all items of packaging from the fan.
2. Lift the decorative cap (7) and secure the base tube (6) onto the decorative base plate (4) using the 4 screws (5) provided.
3. Position the weighted base insert (3) under the decorative base and secure with the L shaped screw and large washer (1 & 2).
4. Assemble the fan head (10) onto the extension tube (9) and tighten the screw knob to lock the head onto the extension tube. Do not over tighten.
5. To adjust the height of the fan, loosen the extension tube locking nut (8), adjust to the required height and tighten the locking nut.

Operating Instructions

1. Use in a dry place, free of excessive humidity and water.
2. To set the fan in motion turn the rotary switches at the back of the unit to the desirable speed:
0 = OFF 1 = LOW 2 = MEDIUM 3 = HIGH
3. Turn the switch knob to OFF and unplug the power cord when the fan is not in use.

Fan Direction Adjustment

1. Do not attempt to make any adjustment to the direction of the grille and fan assembly until the fan has been turned off and unplugged from the socket.
2. To adjust the direction of the fan, hold the grille and gently tilt the fan until the desired position is reached.
3. Plug the fan back into the socket and turn the fan on.

Care and Maintenance

1. Always disconnect the cord from the electrical outlet when cleaning your fan.
2. Light accumulated dust may be removed from the fan with a soft cloth or vacuum cleaner using the dusting brush attachment.
3. Wipe the exterior surfaces of the fan occasionally with a cloth moistened (not dripping wet) with a mild soap solution. Dry the case thoroughly with a soft dry cloth before operating the fan.
4. Avoid the use of gasoline, benzine, thinner etc as they may result in damage to the fan.
5. Store the fan in a clean dry place when not in use.



CAUTION! Do not immerse the fan in water or allow water to drip into the interior of the fan housing as this could create a fire or electric shock hazard.



WARNING! Do not attempt to open or repair the fan yourself. Doing so could void the warranty and cause damage or personal injury.

Omega Altise products are distributed in Australia by MEA,
(A Division of Hagemeyer Brands Australia Pty Ltd)

ABN 28 001 375 686

Locked Bag 4013, Kingsgrove NSW 2208

Phone: 1300 739 033

Fax: 1800 838 899

Email: customerservice@meappliances.com.au

Web: meappliances.com.au