

omega
altise

**OS40P
40cm Chrome
Pedestal Fan**



**Instruction
Manual**

Important Safety Instructions

1. Read all instructions.
2. Disconnect the power plug before dismantling, assembling or before cleaning.
3. Avoid touching mobile parts of the fan.
4. Make sure the fan is on a dry and even surface.
5. Never insert fingers, pencils or any other objects through the guards whenever the power plug is connected, especially while running.
6. The appliance is not intended for use by young children or infirm persons unless they have been adequately supervised by a responsible person to ensure that they can use the appliance safely.
7. Young children or infirm persons should be supervised to ensure that they do not play with the appliance.
8. Do not use the appliance for any other purpose than its intended use.
9. The fan must not be used if the guards are not fastened according to instructions.
10. When the power cord is damaged, it must be replaced by the manufacturer or its service agent or a similarly qualified person in order to avoid a hazard.
11. Do not use your appliance with an extension cord unless it has been checked and tested by a qualified electrician or electrical supplier.

Read all instructions before using this unit. Keep them for future reference.

Specifications

Model	OS40P
Rated Voltage	220-240V / 50Hz
Watts	55W
Controls	Rotary switch

Settings	3 speed
Fan blade size	40cm
Tilt action	Tilting fan head
Oscillation	Oscillating fan head
Warranty	2 year replacement

Parts List

1. Guard bottom screw and nut
2. Front guard
3. Fan blade
4. Locking nut
5. Rear guard
6. Guard bottom nut
7. Fan blade screw
8. Motor shaft
9. Fan motor
10. Oscillating knob
11. Speed control
12. Power lead
13. Knob
14. Pedestal (outer) tube
15. Base
16. Weight
17. Washer
18. Locking nut

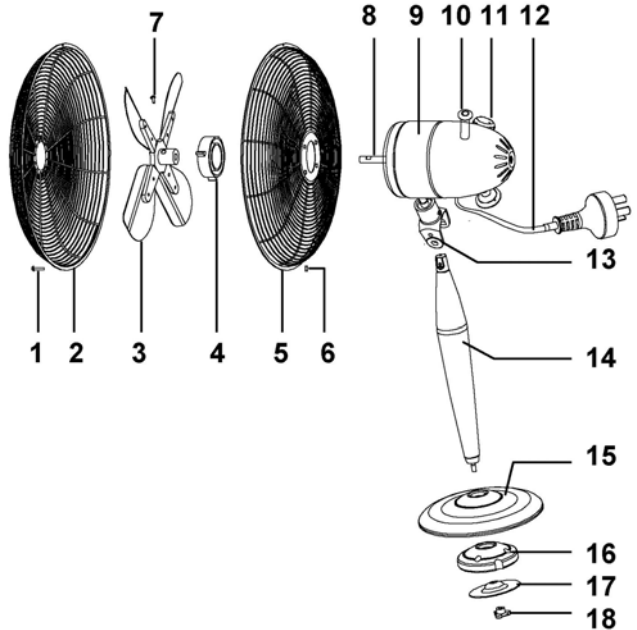

Fan Head

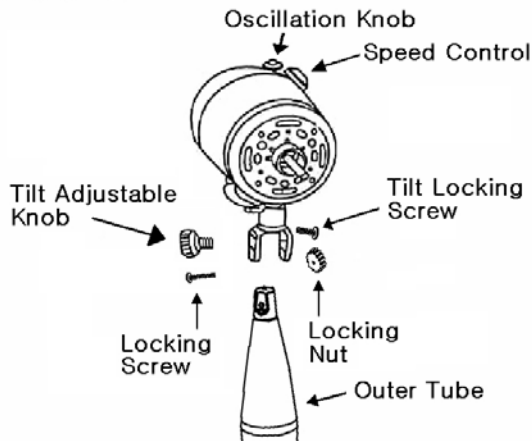

Assembly Instructions

1. Remove all items of packaging from the fan.
2. Fit the weight (16) and washer (17) onto the bottom of the base (15) and fasten to the pedestal tube (14) using the locking nut (18) provided and place on a stable surface.
3. Remove the locking nut from the motor shaft.
4. Position the rear guard over the motor shaft, ensuring that the notches are correctly aligned and then secure with the locking nut. If this is done correctly, the grille's carry handle will be at the top.
5. Where fitted, remove the black plastic tubing from the motor shaft.
6. Align the fan blade with the flat part on the motor shaft and secure by tightening the fan blade screw. The screw should be positioned between the motor housing and the blade.
7. Open all of the locking clips on the front guard. Attach the front guard centre hook to the middle of the rear guard and secure by fastening the locking clips over the outer rim.
8. The guard bottom nut and screw must also be fitted for extra safety precautions.

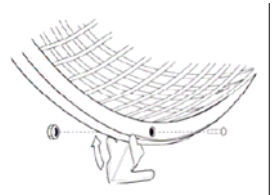
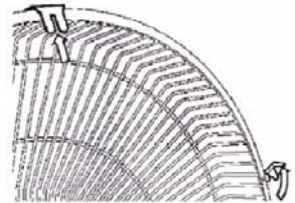

Operating Instructions

1. Use in a dry place, free of excessive humidity and water.
2. To set the fan in motion turn the rotary switches at the back of the unit to the desirable speed:
0 = OFF 1 = LOW 2 = MEDIUM 3 = HIGH
3. Turn the switch knob to 0 and unplug the power cord when the fan is not in use.
4. For oscillation, press down on the knob at the top of the motor housing. To stop oscillation pull the knob upwards.
5. To adjust the height of the fan, loosen the pedestal tube locking nut near the head of the fan, adjust to the required height and tighten the locking nut.

Fan Direction Adjustment

1. Do not attempt to make any adjustment to the direction of the grille and fan assembly until the fan has been turned off and unplugged from the socket.
2. To adjust the direction of the fan, hold the grille and gently tilt the fan until the desired position is reached.
3. Plug the fan back into the socket and turn the fan on.

Care and Maintenance

1. Always disconnect the cord from the electrical outlet when cleaning your fan.
2. Light accumulated dust may be removed from the fan with a soft cloth or vacuum cleaner using the dusting brush attachment.
3. Wipe the exterior surfaces of the fan occasionally with a cloth moistened (not dripping wet) with a mild soap solution. Dry the case thoroughly with a soft dry cloth before operating the fan.
4. Avoid the use of gasoline, benzine, thinner etc as they may result in damage to the fan.
5. Store the fan in a clean dry place when not in use.



CAUTION! Do not immerse the fan in water or allow water to drip into the interior of the fan housing as this could create a fire or electric shock hazard.



WARNING! Do not attempt to open or repair the fan yourself. Doing so could void the warranty and cause damage or personal injury.

Omega Altise products are distributed in Australia by MEA,
(A Division of Hagemeyer Brands Australia Pty Ltd)
ABN 28 001 375 686
Locked Bag 4013, Kingsgrove NSW 2208
Phone: 1300 739 033
Fax: 1800 838 899
Email: customerservice@meappliances.com.au
Web: meappliances.com.au