



# OPERATION, MAINTENANCE AND SAFETY INSTRUCTIONS

FOR OMEGA ALTISE PEDESTAL FAN

MODEL:

OP46BC



## TABLE OF CONTENTS

IMPORTANT SAFETY INSTRUCTIONS .....	1
PRODUCT OVERVIEW .....	2
ASSEMBLY .....	2
OPERATING INSTRUCTIONS .....	3
MAINTENANCE .....	3

## IMPORTANT SAFETY INSTRUCTIONS

### IMPORTANT

Read the safety precautions of this booklet carefully before attempting to assemble, install, operate or maintain the product described. Protect yourself and others by observing all safety information. Failure to comply with instructions could result in personal injury and/or property damage. If you are unsure about anything regarding your fan or these instructions, please contact Omega Altise on 1300 795 572 in Australia or (09) 415 6000 in New Zealand before operating your appliance.

1. Read all instructions carefully before using the tower fan.
2. Use this tower fan only as described in this manual. Any other use not recommended by the manufacturer may cause fire, electrical shock, or injury to persons. Do not modify this appliance. Do not try to repair this appliance – there are no user serviceable parts within.
3. Remove the packaging and ensure that the appliance is undamaged (keep packing box for later storage). In case of doubt do not use the appliance and contact Omega Altise Service. Do not let children play with any parts of the packaging.
4. This appliance is not intended for use by persons (including children) with reduced physical, sensory or mental capabilities, or lack of experience or knowledge, unless they have been given supervision or instruction concerning the use of the appliance by a person responsible for their safety. Children should be supervised to ensure that they do not play with the appliance. Extreme caution is necessary when the tower fan is used by or near children or individuals with decreased mental and physical capacity and whenever the tower fan is left operating unattended.
5. Before you use the appliance, check if the voltage marked on the rating label corresponds to the mains in your home. The appliance must be connected to a grounded power supply.
6. Do not use this appliance with a programmer, timer or any other device that switches the appliance on automatically, since a fire risk exists if the appliance is covered or positioned incorrectly.
7. Do not pull the power cord to disconnect with the power source. Always grasp the plug to pull it out.
8. Do not run power cords under rugs, curtains or other combustible materials. Do not place power cords in areas where they can be a tripping hazard. Do not operate directly below a power outlet.
9. Do not insert any objects into the appliance as it may cause an electric shock or fire or damage to the appliance. Do not block or tamper with the appliance in any manner while it is in operation. To prevent a possible fire, do not cover the appliance in any manner. Do not place on soft surfaces, like a bed, where openings may become blocked.
10. Do not leave the appliance unattended. Always unplug the appliance when not in use. Take care that it is not obstructed when oscillating.



#### WARNING:

**The Function Switch should not be used as the sole means of disconnecting power. Always unplug the power cord before servicing or moving the appliance.**

11. Keep materials such as hair, net curtains, tablecloths & clothes away from the openings of the tower fan, as material may be sucked into the appliance causing injury or damage to property or the appliance.
12. The appliance has hot and arcing or sparking parts inside. It must **NOT** be used in potentially dangerous locations such as flammable, explosive, chemical-laden, corrosive, salty or wet atmospheres. This appliance is intended for general indoor domestic use **ONLY**.
13. This appliance is not intended for use in wet or damp locations. Never locate it where it may fall into a bathtub or other water container.
14. Do not use the tower fan outdoors. Do not use close to windows or in direct sunlight.
15. Always place the appliance on flat, stable surfaces before use. Always place the appliance vertically on its base.
16. **NOTE:** Over time, the grills at the front and rear of the appliance will build up dust & dirt. This should be cleaned regularly to maintain optimum efficiency. Follow the cleaning procedure within this instruction.



#### WARNING:

To avoid danger of electric shock, unplug from outlet when not in use and before cleaning. If the supply cord is damaged, it must be replaced by the manufacturer, its Service Agent or similarly qualified persons in order to avoid a hazard. In order to avoid overheating, do not cover the appliance. Do not use the appliance in the immediate surrounding of a bath, shower or swimming pool.

## PRODUCT OVERVIEW

Model:	OP46BC
Rated Voltage:	220 – 240V ~50Hz
Rated Power Input:	60W

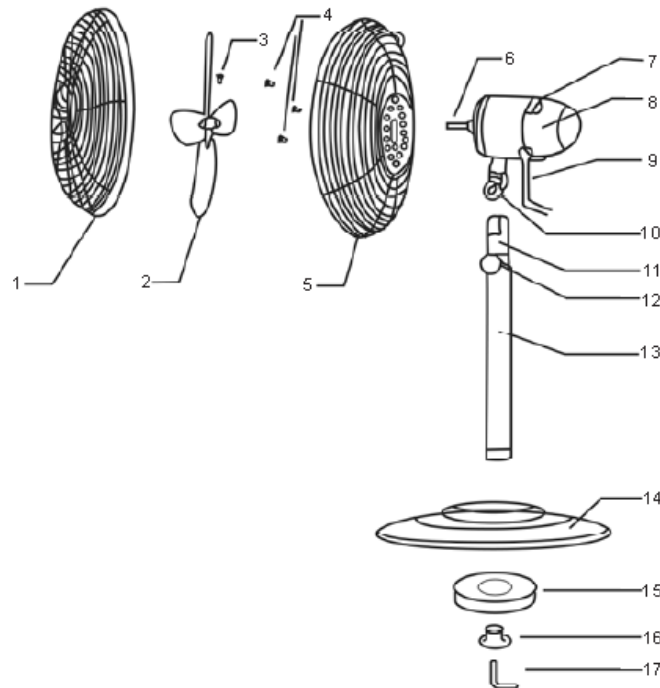

- |                        |                             |                   |
|------------------------|-----------------------------|-------------------|
| 1. Front guard         | 7. Speed control            | 13. Outer tube    |
| 2. Fan blade           | 8. Fan motor                | 14. Base          |
| 3. Fan blade screw     | 9. Mains lead               | 15. Weight        |
| 4. Cover fixing screws | 10. Knob                    | 16. Fastener      |
| 5. Rear guard          | 11. Inner tube              | 17. Locking screw |
| 6. Motor shaft         | 12. Height adjustment screw |                   |

## ASSEMBLY

1. Assemble the base.
2. Insert the outer tube into the base, slide on the weight and secure using the locking screw. Place the assembly upright.
3. Secure the fan motor to the inner tube using the screws provided.
4. Attach the rear guard to the fan motor, securing it in place with the cover fixing screws.
5. Place the locking nut and fan blade on the motor shaft, securing it in place using the fan blade screw.
6. Hold the front guard against the rear guard and secure it in place with the cover fixing screws.

## OPERATING INSTRUCTIONS

Connect the power plug to a suitable outlet.

Select the desired speed using the Speed control:

- 0 – Device Off
- 1 – Low speed
- 2 – Medium speed
- 3 – High speed

The incline of the fan head can be adjusted by tilting it backwards or forwards. The fan head can then be locked into position, which is indicated by an audible click.

To adjust the height, loosen the height adjustment screw, slide the upper section to the required height and re-tighten the adjustment screw.

### Oscillation

The fan head is capable of oscillating in a 75° arc.

To have the fan head oscillate, pull the pin located at the back of the fan head up.

To stop oscillation, simply push the pin down.

## MAINTENANCE

**IMPORTANT:** Before cleaning turn the fan off and unplug from the power supply.

- To clean the fan, use a soft cloth to wipe off any dust. If the fan is very dirty use a damp cloth and wipe dry.
- Do not use any cleaning detergents, sprays or other chemicals, as they will damage the fan.
- Store the fan in the original packing in a ventilated dry area.
- The motor bearings are permanently sealed and do not require additional lubrication.

It is important that you retain these instructions, proof of purchase as well as other important documents about this product for future reference. Due to continual product development, Omega Altise reserves the right to alter specifications or appearances without notice.

Dispose of packaging responsibly – recycle where facilities are available.